

THIS DRAWING IS UNPUBLISHED. RELEASED FOR PUBLICATION, 19  
 © COPYRIGHT 19 BY AMP INCORPORATED. ALL INTERNATIONAL RIGHTS RESERVED.

| LOC | DIST | P | F | REVISIONS |     |                      |         |       |
|-----|------|---|---|-----------|-----|----------------------|---------|-------|
| G   | 14   |   |   | ZONE      | LTR | DESCRIPTION          | DATE    | APPD  |
|     |      |   |   |           | U   | REV PER OG3A-0199-99 | 16FEB00 | JR/TM |

|                                |                                |                                |
|--------------------------------|--------------------------------|--------------------------------|
| <b>AMP</b><br>WIRE RANGE       | <b>UL</b> E13288<br>Listed     | <b>SA</b> LR7189<br>Certified  |
| 22-16 AWG<br>SOLID OR STRANDED | 22-16 AWG<br>SOLID OR STRANDED | 22-16 AWG<br>SOLID OR STRANDED |

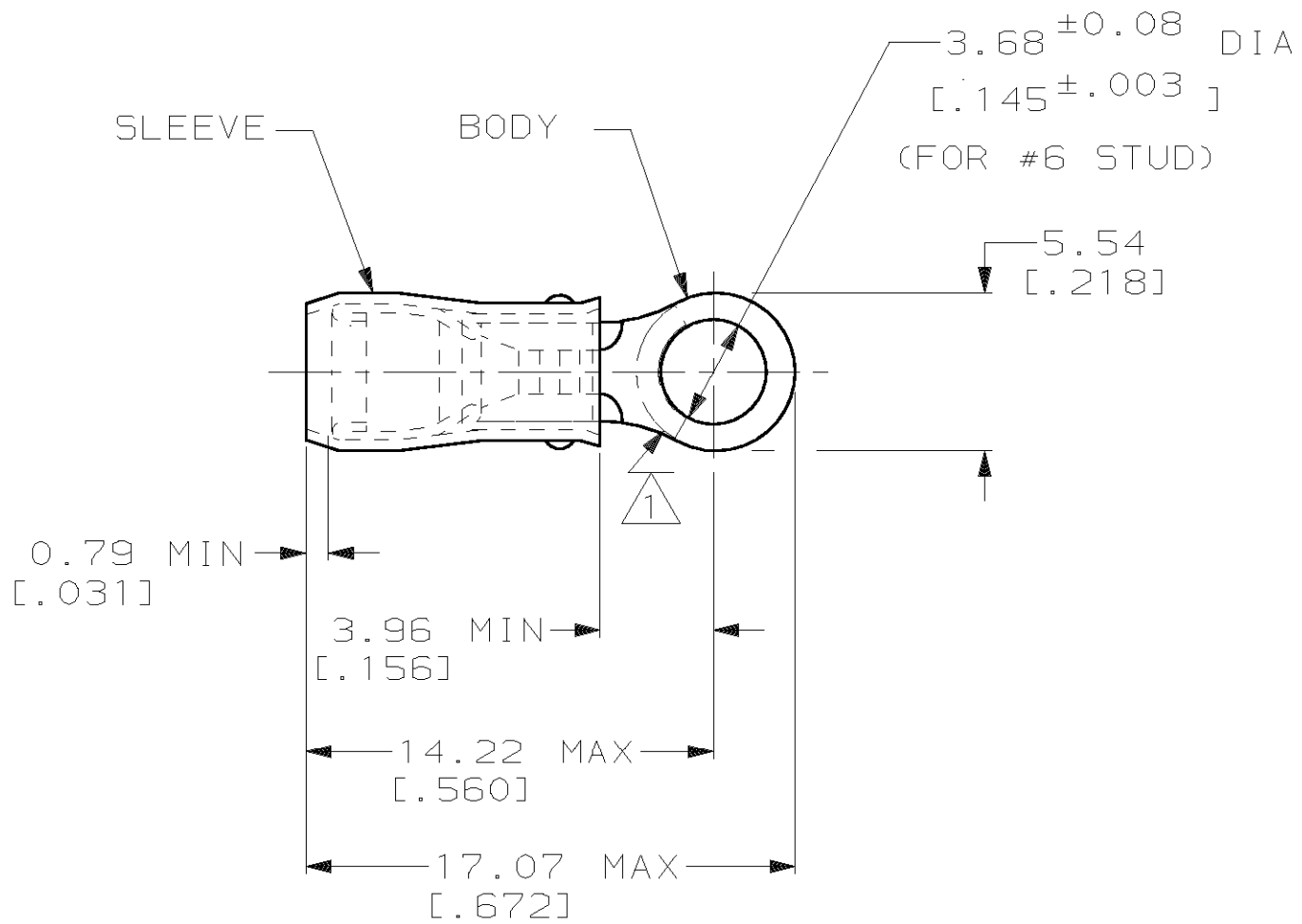

- 1 STAMP AMP 22-18\* APPROX AS SHOWN  
22-16 TERMINALS ARE STAMPED 22-18 IN  
ACCORDANCE WITH MILITARY SPEC MIL-T-7928  
COMMERCIAL WIRE RANGE IS 22-16
- 2 WIRE INSULATION DIA: 2.03 - 3.18  
[0.080 - 0.125]
- 3 TONGUE MATERIAL THK: 0.79±0.05  
[0.031±0.002]

|   |  |  |   |          |   |           |
|---|--|--|---|----------|---|-----------|
| AMP INCORPORATED<br>CUSTOMER SERVICE SYSTEMS  |  | MAX RECOMMENDED OPERATING TEMPERATURE:<br>105°C MAX  | MILITARY P/N AND CLASS  | QUANTITY | PACKAGE TYPE  | PART NO   |
| FOR ADDITIONAL<br>PRODUCT INFORMATION OR<br>COPIES OF DRAWINGS<br>AND TECHNICAL DOCUMENTS | PRODUCT INFORMATION CENTER<br>1-800-522-6752 | VOLTAGE RATING:<br>300 V MAX   | MS25036-101<br>CLASS 2  | 100      | LOOSE PIECE, BOX  | 8-36149-1 |
| FOR APPLICATION<br>TOOLING INFORMATION  | TOOLING ASSISTANCE CENTER<br>1-800-722-1111  | CIRCULAR MIL AREA:<br>0.26-1.65mm <sup>2</sup> [509-3,260] CIR MILS<br>SOLID OR STRANDED   | MS25036-101<br>CLASS 1 & 2  | 5000     | ON TAPE, REEL   | 2-36149-2 |
| FOR ORDER ENTRY   | 1-800-526-5142                               | THIS DRAWING IS A CONTROLLED DOCUMENT FOR<br>AMP INCORPORATED. IT IS SUBJECT TO CHANGE<br>AND THE CONTROLLING ENGINEERING ORGANIZATION<br>SHOULD BE CONTACTED FOR THE LATEST REVISION. | DO NOT SCALE PRINT.<br>UNLESS SPECIFIED<br>DIMENSIONS IN mm [INCHES]<br>TOLERANCES ON:<br>2 PLC DEC ± 0.20[.008]<br>3 PLC DEC ± -<br>ANGLES ± - | 1000     | LOOSE PIECE   | 36149     |
|   |  |  | MATERIAL<br>COPPER PER ASTM B-152<br>SLEEVE, RED NYLON  |          |   |           |
|   |  |  | FINISH<br>TIN PLATE<br>PER ASTM B545  |          |   |           |
|   |  |  | DR 9/8/93<br>DK SCHRUM  |          | AMP AMP Incorporated<br>Harrisburg, PA 17105-3608             |           |
|   |  |  | CHK 9/8/93<br>RE HERSEY   |          | NAME<br>TERMINAL, RING TONGUE,<br>PIDG™, WIRE SIZE, 22-16 AWG |           |
|   |  |  | APPD 9/8/93<br>ML ELLIS   |          | SIZE [B] CAGE CODE 00779 DRAWING NO ©-36149                   |           |
|   |  |  | APPD 9/8/93<br>M BARNABA  |          | SCALE NTS SHEET 1 OF 2  |           |
|   |  |  | PRODUCT SPEC<br>UL 486A   |          |   |           |
|   |  |  | APPLICATION SPEC<br>NOT AVAILABLE   |          |   |           |
|   |  |  | WEIGHT -  |          |   |           |

THIS DRAWING IS UNPUBLISHED. RELEASED FOR PUBLICATION, 19  
 © COPYRIGHT 19 BY AMP INCORPORATED. ALL INTERNATIONAL RIGHTS RESERVED.

| LOC | DIST | P | F | REVISIONS |     |                      |         |       |
|-----|------|---|---|-----------|-----|----------------------|---------|-------|
| G   | 14   |   |   | ZONE      | LTR | DESCRIPTION          | DATE    | APPD  |
|     |      |   |   |           | U   | REV PER OG3A-0199-99 | 16FEB00 | JR/TM |

**AMP**  
WIRE RANGE

SEE TABLE  
STRANDED

3 STRIPES EQUALLY SPACED FOR COLOR CODE: SEE TABLE

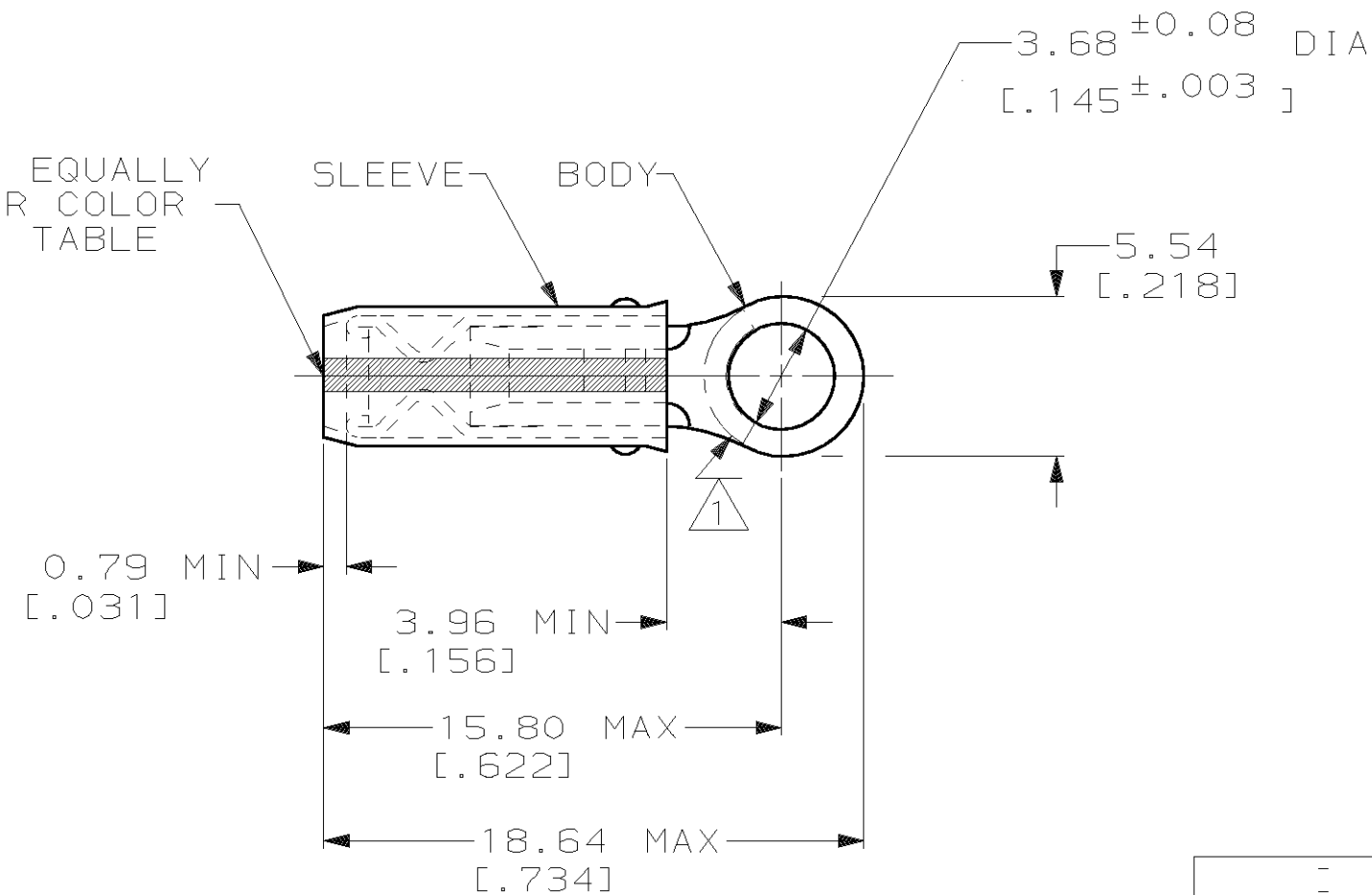

1 STAMP AMP APPROX AS SHOWN SEE TABLE BELOW

2 WIRE INSULATION DIA: 0.97 - 2.79 FOR 22 AWG  
[.038 - .110]

1.17 - 2.79 FOR 20 AWG  
[.046 - .110]

1.42 - 2.79 FOR 18 AWG  
[.056 - .110]

3 TONGUE MATERIAL THK: 0.79 ± 0.05  
[.031 ± .002]

|                        |       |     |    |      |                  |           |
|------------------------|-------|-----|----|------|------------------|-----------|
| -                      | WHITE | 18* | 18 | 100  | LOOSE PIECE, BOX | 9-36149-1 |
| -                      | RED   | 20* | 20 | 100  | LOOSE PIECE, BOX | 7-36149-1 |
| -                      | GREEN | 22* | 22 | 100  | LOOSE PIECE, BOX | 6-36149-1 |
| M7928/1-30 CLASS 1 & 2 | WHITE | 18* | 18 | 1000 | LOOSE PIECE      | 2-36149-5 |
| M7928/1-21 CLASS 1 & 2 | RED   | 20* | 20 | 1000 | LOOSE PIECE      | 2-36149-4 |
| M7928/1-12 CLASS 1 & 2 | GREEN | 22* | 22 | 1000 | LOOSE PIECE      | 2-36149-3 |

|  |  |   |                 |   |   |                                   |           |  |              |                 |
|--|--|---|-----------------|---|---|-----------------------------------|-----------|--|--------------|-----------------|
| <b>AMP INCORPORATED</b>  |  | MAX RECOMMENDED OPERATING TEMPERATURE: 105°C MAX  |                 | MILITARY P/N AND CLASS  | STRIPE COLOR  | STAMPING                          | WIRE SIZE | QUANTITY   | PACKAGE TYPE | PART NO         |
| <b>CUSTOMER SERVICE SYSTEMS</b>  |  | VOLTAGE RATING: 300 V MAX   |                 | DO NOT SCALE PRINT. UNLESS SPECIFIED DIMENSIONS IN mm [INCHES] TOLERANCES ON: |   | DR 9/8/93 DK SCHRUM               |           | <b>AMP</b> AMP Incorporated<br>Harrisburg, PA 17105-3608         |              |                 |
| FOR ADDITIONAL PRODUCT INFORMATION OR COPIES OF DRAWINGS AND TECHNICAL DOCUMENTS | PRODUCT INFORMATION CENTER<br>1-800-522-6752 | WIRE RANGE:   | CIRC MIL AREA:  | 2 PLC DEC ± 0.20 [.008]   |   | CHK 9/8/93 RE HERSEY              |           | NAME<br>TERMINAL, RING TONGUE, I.R., PIDG™, WIRE SIZE, 22-16 AWG |              |                 |
| FOR APPLICATION  | TOOLING ASSISTANCE CENTER<br>1-800-722-1111  | 22  | 0.38mm² [754]   | 3 PLC DEC ± -   |   | APPD 9/8/93 ML ELLIS              |           | SIZE   | CAGE CODE    | DRAWING NO      |
| TOOLING INFORMATION  | 1-800-722-1111                               | 20  | 0.60mm² [1,186] | ANGLES ± -  | MATERIAL<br>COPPER PER ASTM B-152 SLEEVE, RED NYLON | APPD 9/8/93 M BARNABA             |           | B  | 00779        | C-36149         |
| FOR ORDER ENTRY  | 1-800-526-5142                               | 18  | 0.96mm² [1,900] |   | FINISH<br>TIN PLATE PER ASTM B545                   | PRODUCT SPEC<br>-                 |           | SCALE  | NTS          | SHEET<br>2 OF 2 |
|  |  | STRANDED  |                 |   |   | APPLICATION SPEC<br>NOT AVAILABLE |           |  |              |                 |
|  |  | THIS DRAWING IS A CONTROLLED DOCUMENT FOR AMP INCORPORATED. IT IS SUBJECT TO CHANGE AND THE CONTROLLING ENGINEERING ORGANIZATION SHOULD BE CONTACTED FOR THE LATEST REVISION. |                 |   |   | WEIGHT<br>-                       |           |  |              |                 |